

1) Fix the additional ruler to the table

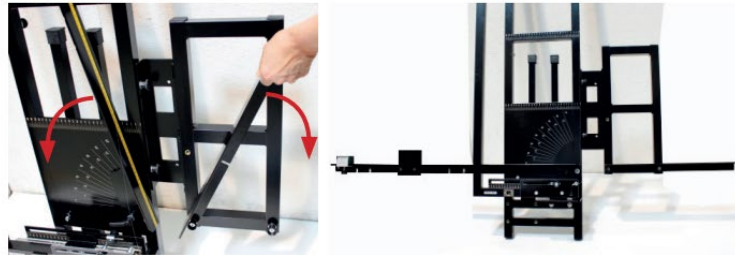

2) Unfold both rule



3) Unfold the front stands

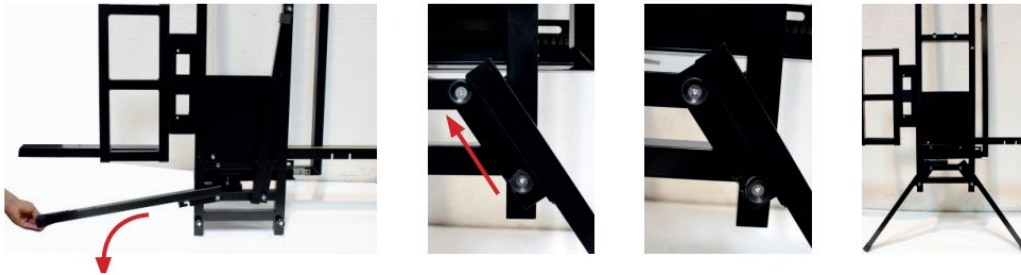

4) Fix the back stand to the table



5) Frame holder position on the table



The eccentric wheel allows to level the main rule to 0°

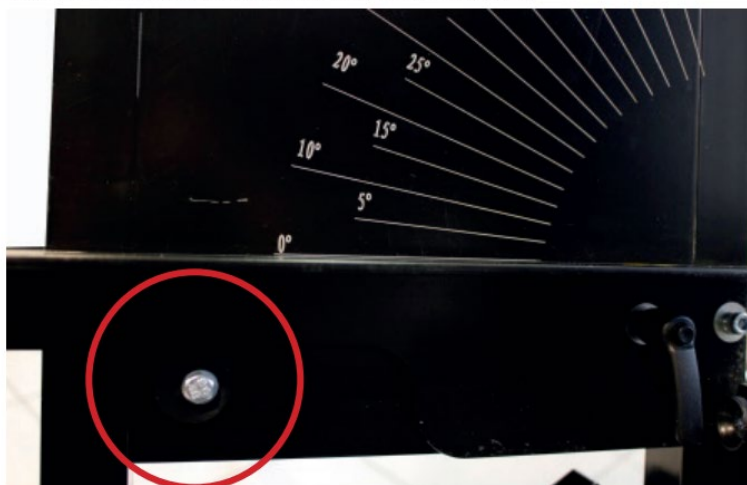

Adjust the additional rule positioning to be perfectly straight with the main rule



Adjust the stopper to -2cm to avoid the hot wire touching the ruler at the end of the cut



To replace the hot wire, unscrew the nut to loosen the spring

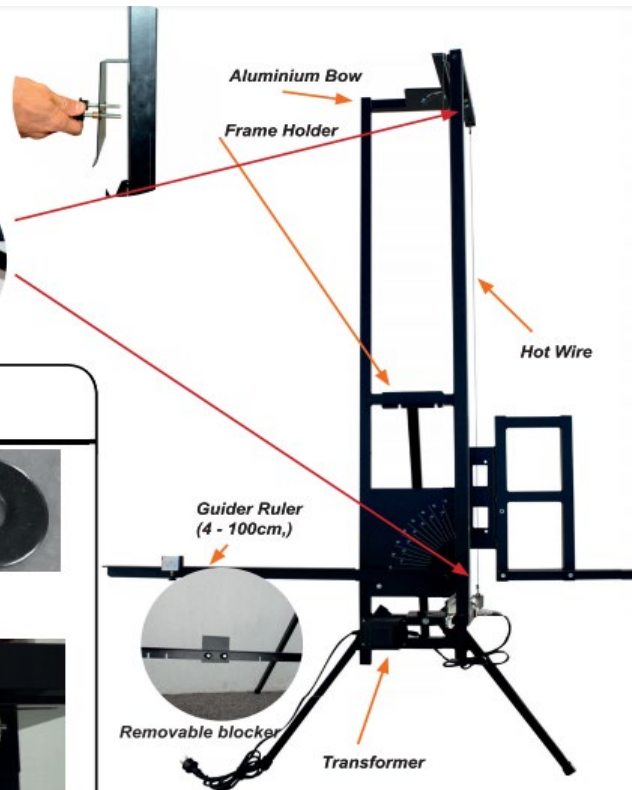
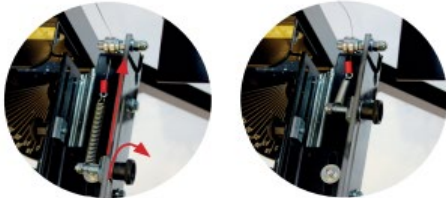

### TRANSFORMER ASSEMBLY



**A**  
M6 x 20 mm  
X4 PCS



**B**  
X1 PC



**C**  
X1 PC

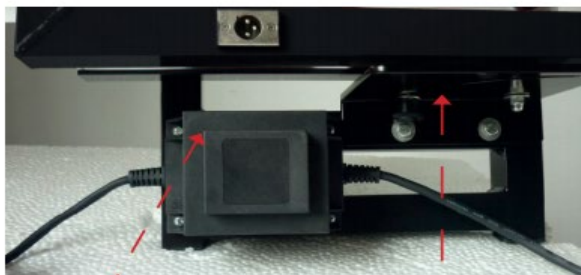

**A**

**B+C**

